

Revolve



A PROJECT BY





READY, SET, REVOLVE!



Operations & Facility management Tenant mix & leasing Management



EGYPT – UAE – QATAR – KSA – LEBANON – LIBYA – ALGERIA – CYPRUS – COTE D'IVOIRE - CAMEROON

REVOLVE LOCATION

Our choice of location within the sprawling & promising city of New Cairo was a strategic decision on all fronts. Not only is it a prime residential area; it is a perfect host for all entities from massive multinationals to budding startups.

- 1 minute from Rehab City
- 2 minutes from North 90 st.
- 2 minutes from the South 90 monorail station
- 5 minutes from the Golden Square
- 5 minutes from the Prosecutor General Office
- 5 minutes from AUC
- 5 minutes from Suez rd.
- 10 minutes from the New Capital via Mohamed Bin Zayed Axis
- 15 minutes from Cairo Airport

Revolve location

- Our choice of location within the sprawling & promising city of New Cairo was a strategic decision on all fronts. Not only is it a prime residential area; it is a perfect host for all entities from massive multinationals to budding startups, connecting New Cairo to the New Capital.

Revolve™

Accessible Location

- 01 minute from Al Rehab City
- 02 minutes from North/South 90 st.
- 05 minutes from AUC
- 05 minutes from suez road
- 05 minutes from the Golden Square
- 10 minutes from the New Capital
- 15 minutes from Cairo International Airport





BIRDS EYE VIEW





RIGHT WING





LEFT WING





CENTRAL PLAZA





UNDERGROUND PARKING ENTRANCE



MALL FACILITIES

- Double-height dining and upscale retail units
- Office spaces
- Double-height serviced apartments
- ATM Center
- Storage and Locker Areas
- Continuous marketing activities
- Digital ad slot displays
- Underground parking
- 24/7 CCTV and advanced security systems
- Central chiller AC system
- Round the clock facility management, housekeeping, maintenance and technical support
- Garbage Chute System
- Emergency power systems
- Fire alarm system
- Fiber optic cables
- Prayer rooms
- Landscapes and scenic views with different moods
- Outdoor seating overlooking the main plaza landscape and side street
- Frequent and on-demand disinfection and sanitization
- Open air spaces for direct access to the sun and air





ADMIN RECEPTION



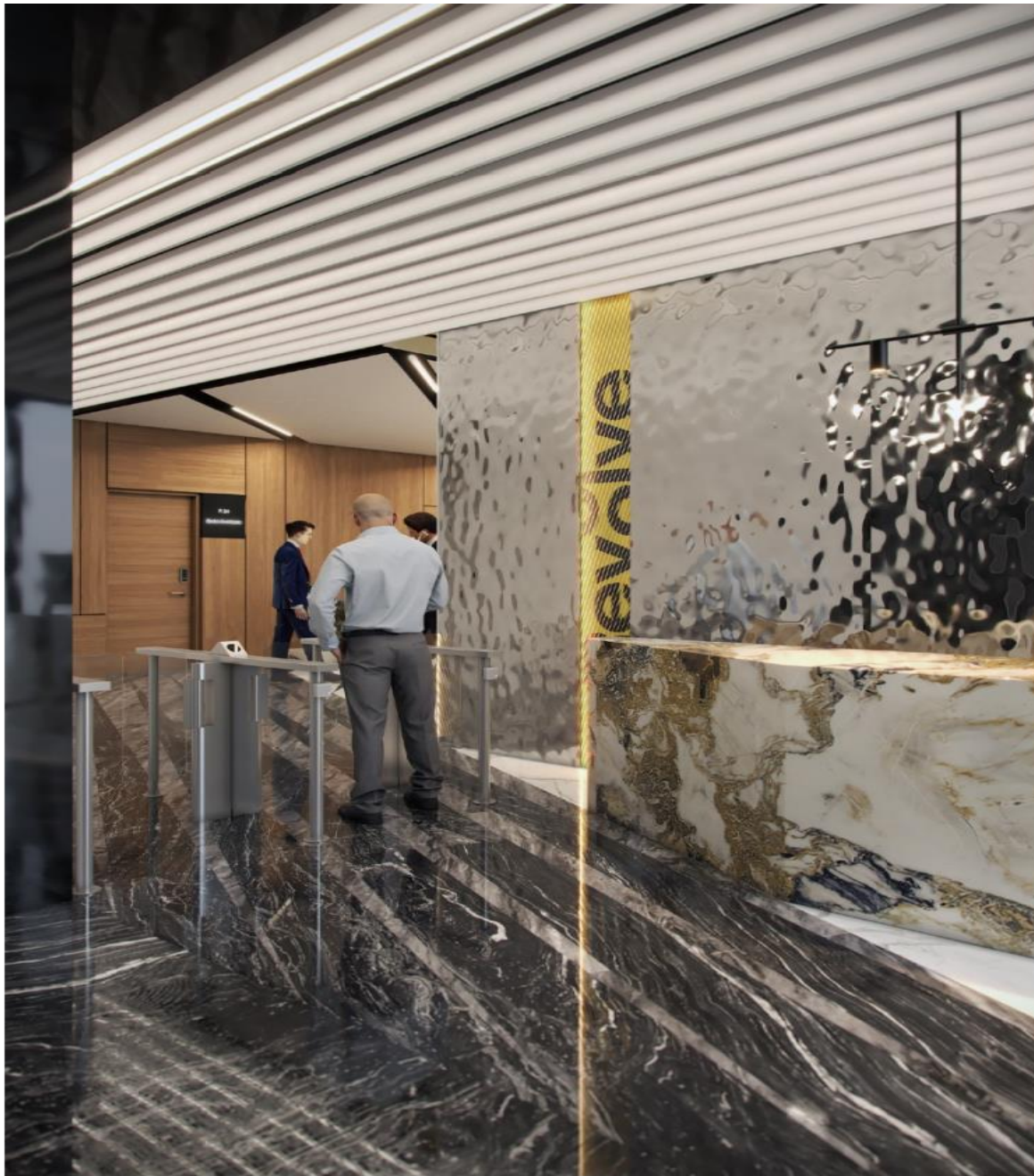

OFFICES ENTRANCE



OFFICES WAITING AREA





OFFICES WAITING AREA





OFFICES CORRIDOR



ADMIN FACILITIES

- Exclusive entrance with elevator other than plaza main gate
- Front desk reception
- Visitors management system
- Public waiting areas
- Mindful co-working spaces designed to connect
- Common meeting rooms for maximized space utilization
- Business Center
- Vending machines on each floor
- World-class fire and security systems
- Emergency power systems
- Wheelchair accessible elevator access
- Underground parking
- Garbage chute system
- Round the clock facility management, maintenance and technical support
- Smart building features with fiber optic support
- Free flowing workspace design
- Dedicated spaces for casual and formal gatherings



commercial Unit A 22-01

Area: 181 sqm

Ceiling Hight: 6.25 m

Price 43,775,908EGP

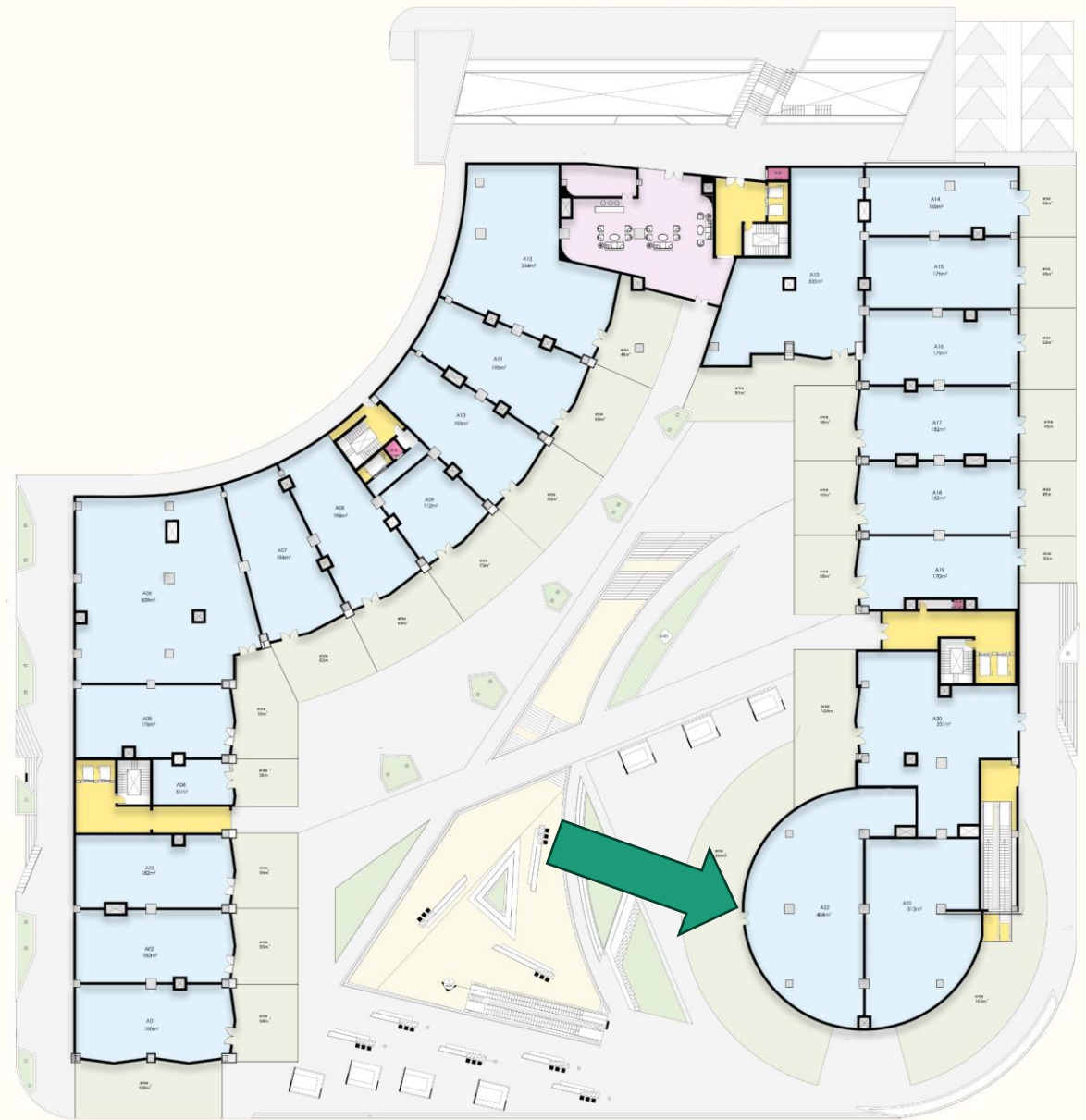

Ground floor Plan

PAYMENT PLAN

Date	27-Dec-2023
Unit No	A22-01
Indoor Meter	181
Indoor Price	241,856
Outdoor Meter	0
Outdoor Price	80,619
Total Value	43,775,908
Discount%	0.0%
Discount (L.E)	0.00
Net Selling Price	43,775,908
Down payment	15%
Balance	(6,566,386)

Project Name	REVOLVE MALL
Expected delivery Date	1-Mar-25



No. of installment	12				
Term	6				
Maintenance deposit	10%	4,377,591	Due on	1-Mar-25	
Payment Interval	Semi Annual	6		No. of PMT /Year	2
Year	Installment	Amount	%	Due Date	Balance
Down payment		6,566,386	15.0%	27-Dec-2023	37,209,522
2024	1	4,085,752	9.3%	25-Jun-24	33,123,770
2024	2	4,085,752	9.3%	25-Dec-24	29,038,019
2025	3	4,085,752	9.3%	1-Mar-25	24,952,267
2025	4	2,772,474	6.3%	1-Sep-25	22,179,793
2026	5	2,772,474	6.3%	1-Mar-26	19,407,319
2026	6	2,772,474	6.3%	1-Sep-26	16,634,845
2027	7	2,772,474	6.3%	1-Mar-27	13,862,371
2027	8	2,772,474	6.3%	1-Sep-27	11,089,896
2028	9	2,772,474	6.3%	1-Mar-28	8,317,422
2028	10	2,772,474	6.3%	1-Sep-28	5,544,948
2029	11	2,772,474	6.3%	1-Mar-29	2,772,474
2029	12	2,772,474	6.3%	1-Sep-29	0
		43,775,908	100%		

PAYMENT PLAN

Date	27-Dec-2023
Unit No	A22-01
Indoor Meter	181
Indoor Price	241,856
Outdoor Meter	0
Outdoor Price	80,619
Total Value	43,775,908
Discount%	0.0%
Discount (L.E)	0.00
Net Selling Price	43,775,908
Down payment	10% (4,377,591)
Balance	39,398,317

Project Name **REVOLVE MALL**

Expected delivery Date **1-Mar-25**



No. of installment	10				
Term	5				
Maintenance deposit	10%	4,377,591	Due on	1-Mar-25	
Payment Interval	Semi Annual	6		No. of PMT /Year	2
Year	Installment	Amount	%	Due Date	Balance
Down payment		4,377,591	10.0%	27-Dec-2023	39,398,317
2024	1	5,253,109	12.0%	25-Jun-24	34,145,208
2024	2	5,253,109	12.0%	25-Dec-24	28,892,099
2025	3	5,253,109	12.0%	1-Mar-25	23,638,990
2025	4	3,376,999	7.7%	1-Sep-25	20,261,991
2026	5	3,376,999	7.7%	1-Mar-26	16,884,993
2026	6	3,376,999	7.7%	1-Sep-26	13,507,994
2027	7	3,376,999	7.7%	1-Mar-27	10,130,996
2027	8	3,376,999	7.7%	1-Sep-27	6,753,997
2028	9	3,376,999	7.7%	1-Mar-28	3,376,999
2028	10	3,376,999	7.7%	1-Sep-28	0
		43,775,908	100%		